

Model #: AS702-ZB

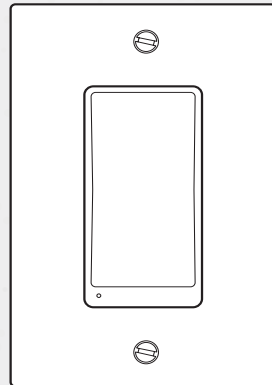

- Momentary paddle buttons for on/off and dim up/down control.
- Control one or more remote lighting zone(s), depending on setup.
- Universal 120-277VAC input.
- RGB status/locator LED.
- Connect wirelessly via Zigbee 3.0 or Autani EnergyCenter.
- Neutral wire required.
- Interchangeable white, beige, and black cover plates available.
- 5 year limited product warranty.

2



- Turn power **OFF** at the circuit breaker before installing the sensor.
- Sensor must be installed and used in accordance with appropriate electrical codes and regulations.
- Installation to be performed by a qualified and trained electrician.

3

DIMENSIONS

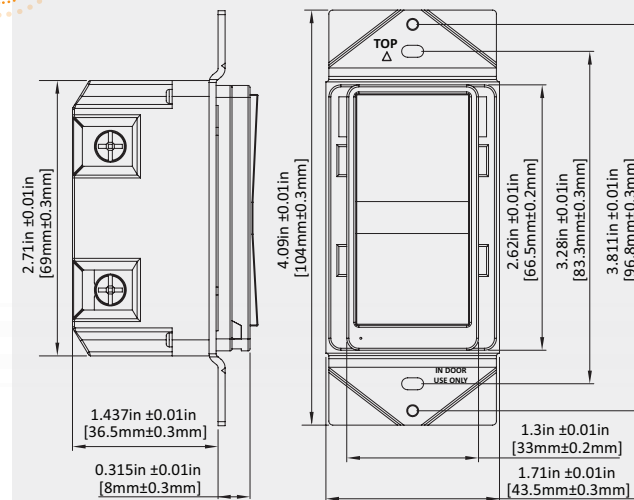

4

WIRING DIAGRAM

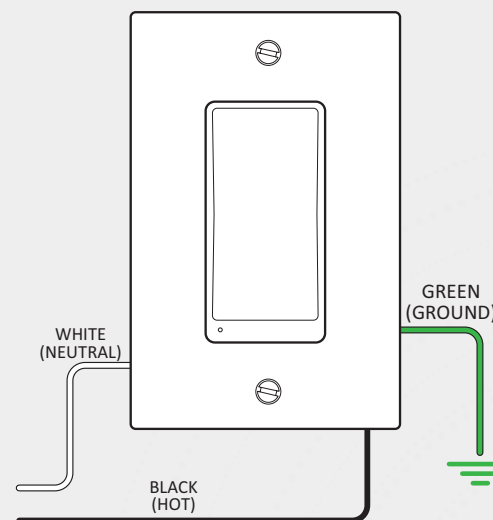

5

MOUNTING/INSTALLATION

Press fit the switch button to a 3-way switch. And then install the complete switch to the junction box using the mounting screws.

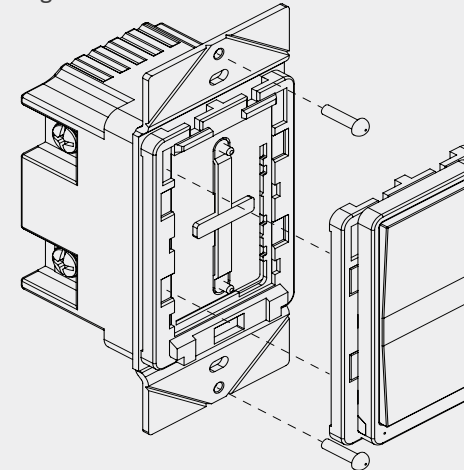

ZIGBEE RADIO RESET INSTRUCTIONS

To reset the switch, press and hold both the buttons for 11 seconds. The lighting load will transition and the LED at bottom of switch will flash.

Once the reset is performed successfully, the device will search for a network and can be added through EnergyCenter®.

NOTE: If the LED is blinking, then its searching for a network.

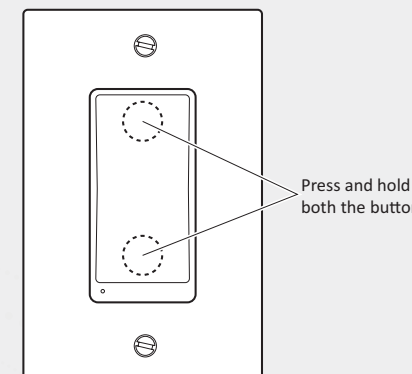

Colors	Meaning
Solid Green	No Network
Flashing Green	Joining/Leaving Network
No green	Joined to Network
Flashing Red	Switch Lockout
Flashing Blue	Identify

6

COMMISSIONING

All setup is performed through Autani EnergyCenter and Autani Lite. EnergyCenter allows for automated schedules, timers, and scenes.

OPERATION

After it is commissioned the switch can be programmed to apply ON/OFF control and step dimming to a remote fixture group. All aspects and sequence of operations are configurable through EnergyCenter or Autani Lite's.

SERIAL NUMBER INFORMATION AND TRACKING

The serial number or ID of a device is used to track device installation locations and details for the commissioning process. The identification information for each device should be tracked in a meaningful way, many devices include duplicate 'stickers' with this information. Autani provides an iOS app to assist with the process.



For help getting starting with the iOS Commissioning App please see Autani's User Guide for the iOS Commissioning App.

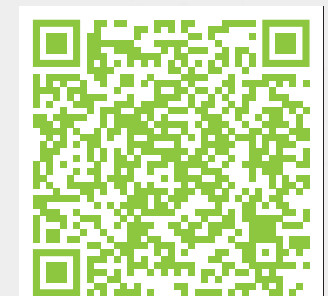

Once commissioning details are collected, either through the iOS Commissioning App, or by tracking identifiers on drawings/spreadsheets. Please provide this information to support@autani.com to begin the commissioning process.

1

On the provided list of device serial numbers, document the location for each Switch on the back side.

EXAMPLE

MAC: XXXXXXXXXXXX