

Zigbee Model #: ZBS-TA08

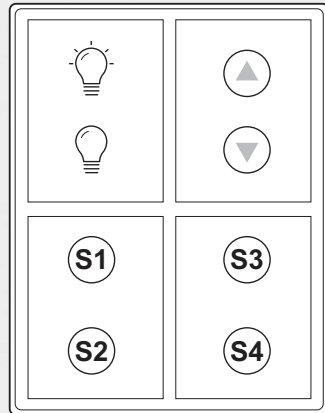

- Zigbee HA 1.2 compatible; control lighting fixtures wirelessly.
- 4-button touch pad with LED back-light.
- Fits standard off-the-shelf switch covers.
- Fits in standard wall switch junction box.
- 100VAC-277vVAC full range input for no-worry installation.
- High interoperability in compliant to global Zigbee standards.
- State-of-the-art algorithms providing seamless smooth dimming effect.
- Easy commissioning, easy to use and easy to control.
- Standard Zigbee OTA makes updating easy and current.
- 3 year limited product warranty.

SPECIFICATIONS

Compatibility: Zigbee HA 1.2
 Input: 110-277VAC/50-60Hz
 Operating Environment: -20 to +65°C
 Radio Properties: 2.4 GHz, +19.5dBm TX Power
 Antenna: Internal Built-in, External N/A
 LED Indicators: Solid (in network), Flash (Pairing)
 Controls: (4 buttons) On/Off/dim/4 scenes

1



- Turn power **OFF** at the circuit breaker before installing the sensor.
- Sensor must be installed and used in accordance with appropriate electrical codes and regulations.
- Installation to be performed by a qualified and trained electrician.

2

On the provided list of device serial numbers, document the location for each Switch on the back side or any side of the device.

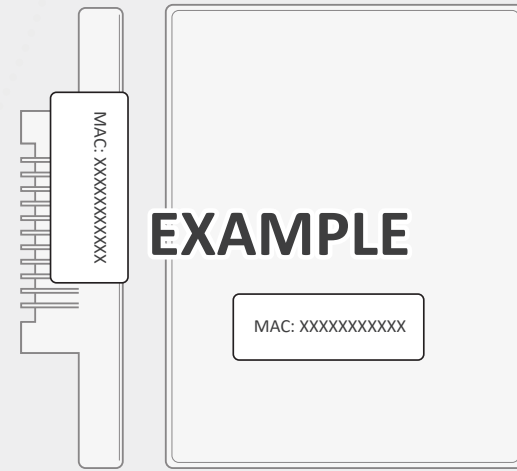

3

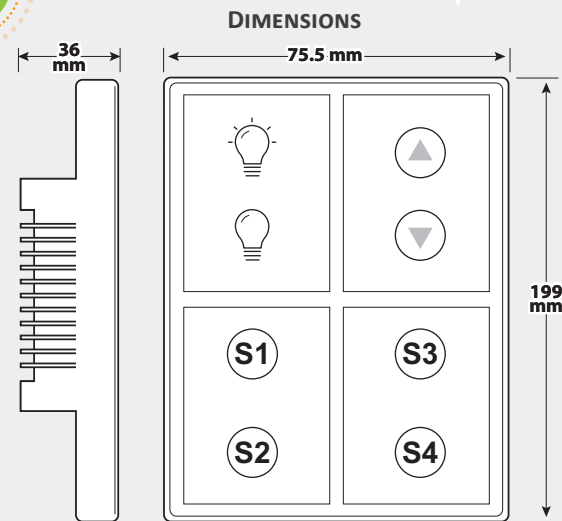

INSTALLATION/REMOVAL

Separate plastic mounting plate from the main body of wall switch for the next step.

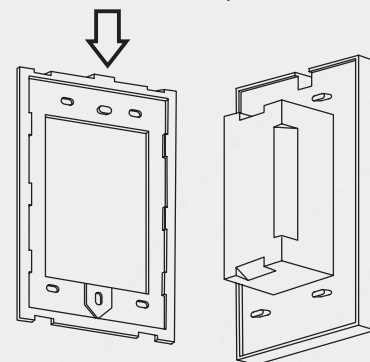

4

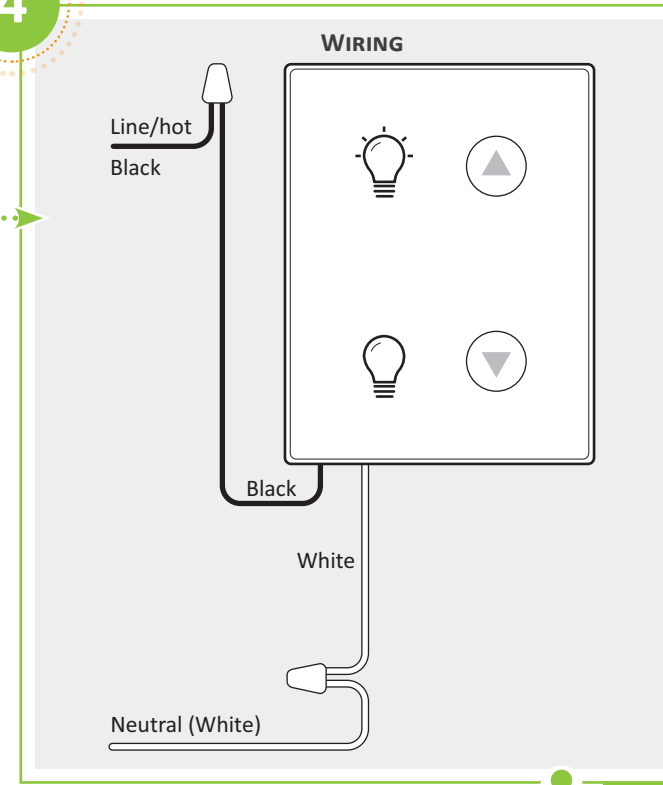

5

ZIGBEE RADIO RESET INSTRUCTIONS

Hold the "top left" + "bottom left" + "top right" buttons simultaneously for 10 seconds.

Once the reset is performed successfully, the device will search for a network and can be added through EnergyCenter®.

NOTE: If the LED is blinking, then its searching for a network.



Colors	Meaning
Solid Green	No Network
Flashing Green	Joining/Leaving Network
No green	Joined to Network
Red	Motion
Flashing Blue	Identify

SERIAL NUMBER INFORMATION AND TRACKING

The serial number or ID of a device is used to track device installation locations and details for the commissioning process. The identification information for each device should be tracked in a meaningful way, many devices include duplicate 'stickers' with this information. Autani provides an iOS app to assist with the process.



For help getting starting with the iOS Commissioning App please see Autani's User Guide for the iOS Commissioning App.



Once commissioning details are collected, either through the iOS Commissioning App, or by tracking identifiers on drawings/spreadsheets. Please provide this information to support@autani.com to begin the commissioning process.