

# Device Reset Guide

## 1.1. Autani Smart Switches

Autani smart switches can be added to the app to control individual lights or groups. Depending on the type of switch, up to three scenes can be assigned to a button. Switches automatically stop pairing mode after 30 seconds or when a button is pressed. They are added to the zones in which they are located.

## 1.2. Add a Switch

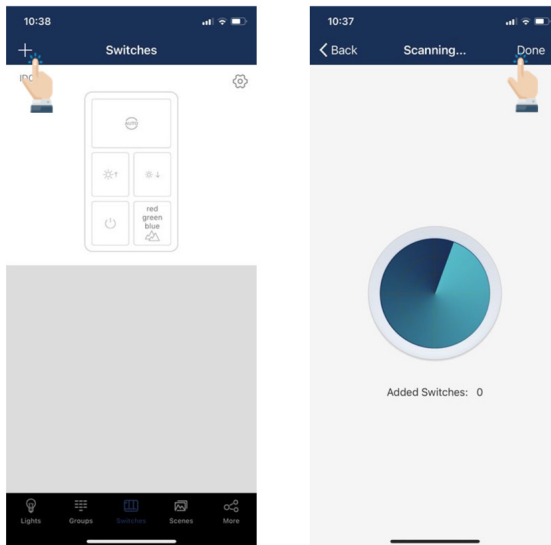

**Note:** Set the switch to pairing mode, then select “+” in the app to add the switch to the appropriate zone.

1. Open the **Switches** page in the app.
2. Tap the “+” button in the upper left corner.
3. The app will search for nearby switches.

## 1.3. LiteTrace Switch Reset Instructions

Follow the instructions below to pair or reset each switch type:

### 1.3.1. WP1025

Press and hold "Auto" and "Dim Up" simultaneously for **2 seconds** to enter pairing mode or reset.

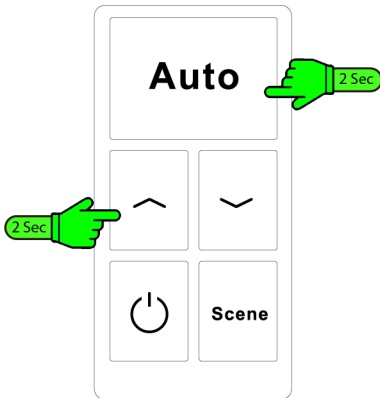

### 1.3.3. WP1055

Press and hold "Auto" and "^" simultaneously for **2 seconds** to enter pairing mode or reset.

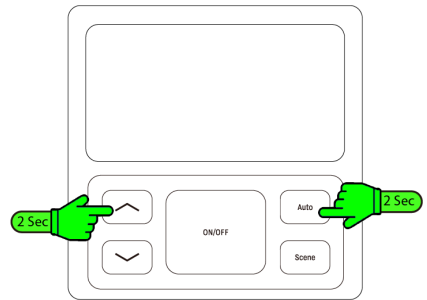

### 1.3.2. WP1075

Press and hold buttons 5 and 6 (Dim Up and Dim Down) simultaneously for **3 seconds** to enter pairing mode or reset.

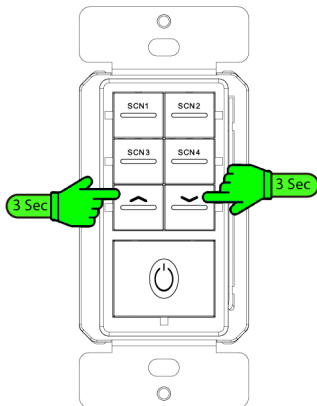

### 1.3.4. WP1013S

Press and hold "ON/OFF" and "Dim Up" simultaneously for **3 seconds** to enter pairing mode or reset.

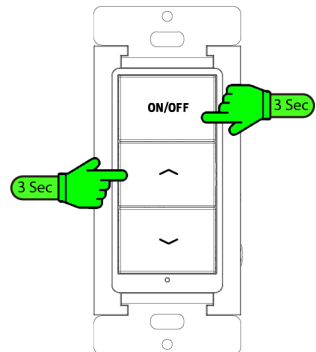

### 1.3.5. WP1013

Press and hold **"ON/OFF"** and **"^"** simultaneously for **3 seconds** to enter pairing mode or reset.

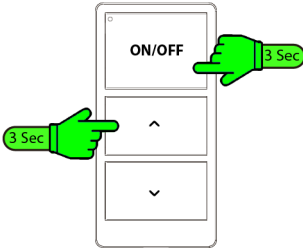

### 1.3.6. WF20R

Press and hold for **6 seconds** to reset the controller to factory settings. The device will be ready to pair with the Keilton app, and the relay will click to confirm.

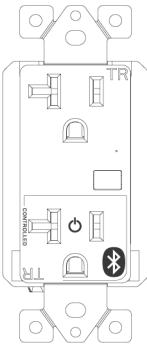

### 1.3.7. WP1018

Simultaneously press and hold **"DIM +"** and **"ON"** for **2 seconds** to enter pairing mode.

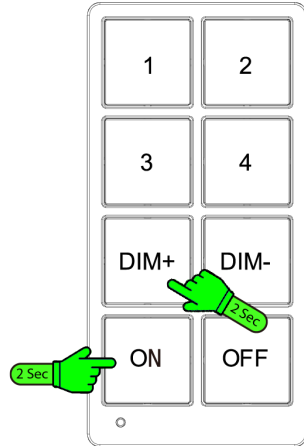

**Autani LLC**

7001 Columbia Gateway Drive, Suite 210, Columbia, MD 21046 USA  
(443) 320-2233 | (240) 755-0092 (fax) | [www.autani.com](http://www.autani.com)

This document contains the Proprietary and Confidential Information of Autani, LLC. Any use of this information without the expressed written consent of Autani, LLC is prohibited. Copyright Autani, LLC 2010-2025. All rights reserved. Please refer to [www.autani.com/legal](http://www.autani.com/legal) for licensing, intellectual property, and other legal notices and information.