

- ❑ The maximum load capacity for the combination of both SmartLet outlets is 15 Amps.
- ❑ There are no user-serviceable parts inside the SmartLet. Unauthorized dismantling will void the warranty. For warranty information, see www.autani.com/legal

2

On the provided list of device serial numbers, document the location for each SmartLet.



4

Remove the screw from the electrical outlet wall plate. Remove the wall plate if it is metal or interferes with mounting the SmartLet flush to the wall.



An unsecured metal wall plate could come in contact with the SmartLet plug prongs, causing risk of shock.

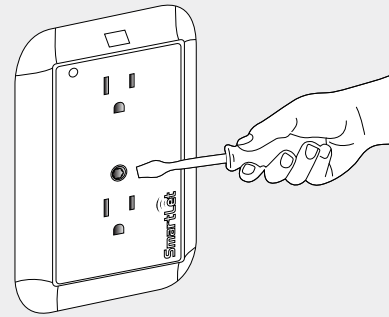

NOTE: The SmartLet can be plugged into a NEMA 5-15R or NEMA 5-20R receptacle. The load switching capacity is 15 Amps.



NEMA 5-15R



NEMA 5-20R

6

Screw the SmartLet to the electrical outlet using a T10 Torx screwdriver and the provided T10 Torx screw.

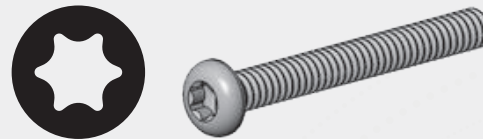

T10 torx screw	U.S.	Metric
Length	1.25 in.	31.75 mm
Point-to-Point	0.107 in.	2.72 mm
Maximum Torque Range	2.7 to 3.3 ft lb	3.7 to 4.5 nm

SERIAL NUMBER INFORMATION AND TRACKING

The serial number or ID of a device is used to track device installation locations and details for the commissioning process. The identification information for each device should be tracked in a meaningful way, many devices include duplicate 'stickers' with this information. Autani provides an iOS app to assist with the process.

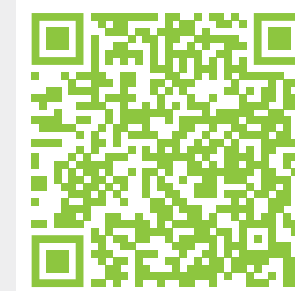

For help getting starting with the iOS Commissioning App please see Autani's User Guide for the iOS Commissioning App.

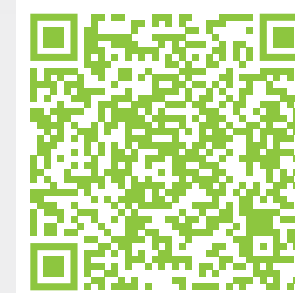

Once commissioning details are collected, either through the iOS Commissioning App, or by tracking identifiers on drawings/spreadsheets. Please provide this information to support@autani.com to begin the commissioning process.